

# Protective Lids

---

INFICON CF quality fittings are manufactured according to ISO 3669 and the latest TS/ ISO 3669-2 standard. INFICON Ultra high vacuum fittings are designed for applications down to  $1 \times 10^{-12}$  mbar and bakeout temperatures up to 400°C.



## BENEFITS

---

- World wide logistics
- 2011/65/EU RoHS compliant

## ORDER INFORMATION

---

Type	DN 16 CF	DN 40 CF	DN 63 CF	DN 100 CF	DN 160 CF	DN 200 CF
Protective cover DN 100 CF				213-444		
Protective cover DN 16 CF	213-441					
Protective cover DN 160 CF					213-445	
Protective cover DN 200 CF						213-446
Protective cover DN 250 CF						
Protective cover DN 40 CF		213-442				
Protective cover DN 63 CF			213-443			

DN 250 CF

213-447

## SPECIFICATIONS

Type	DN 16 CF	DN 40 CF	DN 63 CF	DN 100 CF	DN 160 CF	DN 200 CF
Dimension A	36	71.5	115.5	154	205	263
Dimension B	34	69.5	113.5	152	202.5	254
Dimension C	9.5	17.5	22	24.5	27	26.5
Material:	Polyethylene	Polyethylene	Polyethylene	Polyethylene	Polyethylene	Polyethylene

## DIMENSIONS

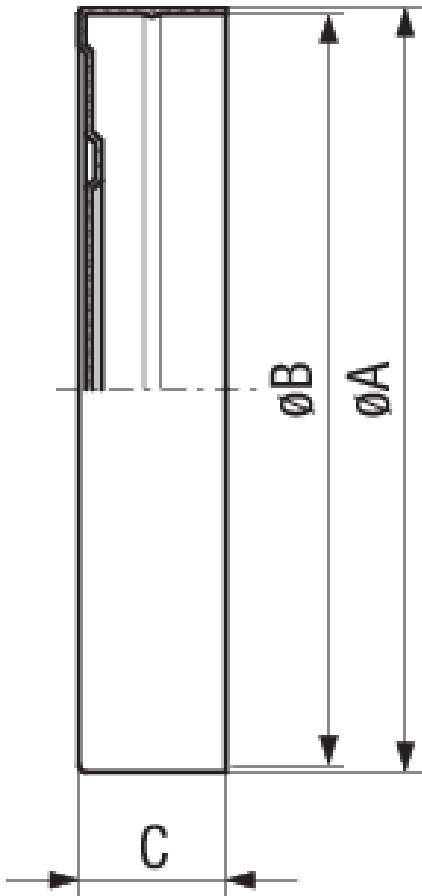

## SPECIFICATIONS

Type	DN 250 CF
Dimension A	308
Dimension B	304
Dimension C	31
Material:	Polyethylene



[www.inficon.com](http://www.inficon.com)    [reachus@inficon.com](mailto:reachus@inficon.com)

Due to our continuing program of product improvements, specifications are subject to change without notice.  
RateWatcher is a trademark of INFICON. All other trademarks are the property of their respective owners.

(2018-08)    © 2018 INFICON