

# METAL-CERAMIC CONNECTIONS

## Vacuum Feedthroughs

### PROPERTIES

- ◆ High grade materials allow repeated bakings up to 400°C



### SELECTION DATA

Voltage <sup>1)</sup>	3 kV	2 kV	5 kV	10 kV
-----------------------	------	------	------	-------

### ORDERING INFORMATION

Part No.	214-161	214-162	214-163	214-164
----------	---------	---------	---------	---------

### SPECIFICATIONS

Insulator		Al <sub>2</sub> O <sub>3</sub>	Al <sub>2</sub> O <sub>3</sub>	Al <sub>2</sub> O <sub>3</sub>	Al <sub>2</sub> O <sub>3</sub>
Connection		Fe-Ni	Fe-Ni	Fe-Ni	Fe-Ni
a		Fe-Ni	stainless steel	stainless steel	stainless steel
b		Fe-Ni	304/1.4301	304/1.4301	304/1.4301
Bakeout temperature	°C	400	400	400	400
Tightness	mbar l/s	5 x 10 <sup>-11</sup>	5 x 10 <sup>-11</sup>	5 x 10 <sup>-11</sup>	5 x 10 <sup>-11</sup>
Weight	g	5	12	25	90

<sup>1)</sup> Based on VDE 0110 for air and surface-leakage in atmosphere on both sides.  
Higher values up to factor two are admissible in pressures <10<sup>-4</sup> mbar.

## DIMENSIONS

214-161

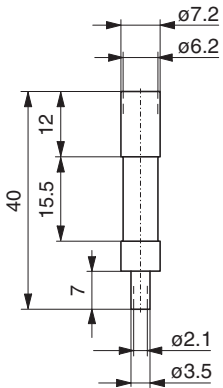

214-162

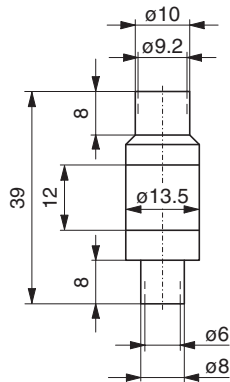

214-163

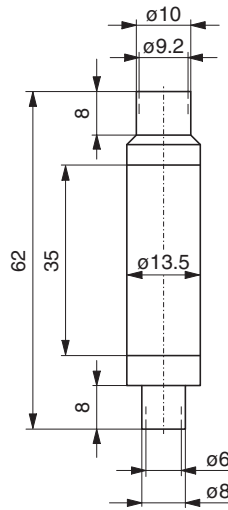

214-164

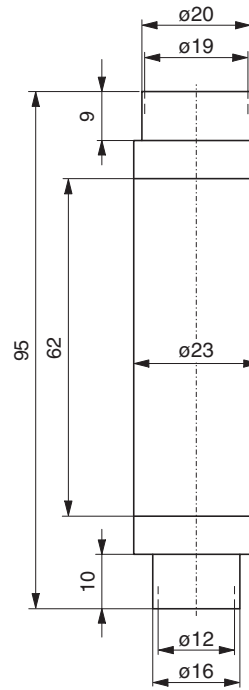

[mm]



**GLOBAL HEADQUARTERS:**

Two Technology Place, East Syracuse, NY 13057 USA  
 Tel: +1.315.434.1100 Fax: +1.315.437.3803 E-mail: reachus@inficon.com

UNITED STATES FRANCE GERMANY LIECHTENSTEIN SWITZERLAND UNITED KINGDOM CHINA JAPAN KOREA SINGAPORE TAIWAN

Visit our website for contact information and other sales offices worldwide. [www.inficon.com](http://www.inficon.com)  
 Due to our continuing program of product improvements, specifications are subject to change without notice.  
 riba15e1-a (2008-05) ©2008 INFICON Inc.