

DN 10-40

Ball Valves with ISO-KF Flanges

ADVANTAGES

- Rugged and cost effective
- Simple opening and closing by lever
- Unobstructed passage



SELECTION DATA

Vacuum connection	DN 10 ISO-KF	DN 16 ISO-KF	DN 25 ISO-KF	DN 40 ISO-KF
-------------------	--------------	--------------	--------------	--------------

ORDERING INFORMATION

Part No.	215-860	215-861	215-862	215-863
----------	---------	---------	---------	---------

SPECIFICATIONS

Tightness	mbar/l/s	1×10^{-5}	1×10^{-5}	1×10^{-5}	1×10^{-5}
Conductance for molecular flow	l/s	1.5	3	9	30
Pressure absolute min./max.	mbar/bar	$10^{-5} / 5^{1)}$	$10^{-5} / 5^{1)}$	$10^{-5} / 5^{1)}$	$10^{-5} / 5^{1)}$
Bakout temperature	°C	80	80	80	80
Housing		brass nickel plated	brass nickel plated	brass nickel plated	brass nickel plated
Seals		PTFE	PTFE	PTFE	PTFE
Weight	kg	0.35	0.35	0.35	0.35

1) With outer centering ring

DIMENSIONS

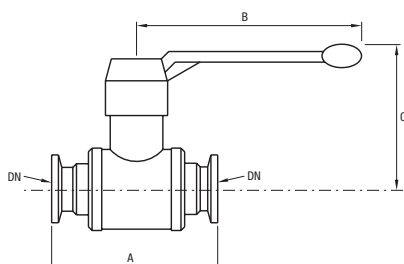

DN	A	B	C
DN 10 ISO-KF	75	83	47
DN 16 ISO-KF	100	95	51
DN 25 ISO-KF	130	110	64
DN 40 ISO-KF	160	160	85



GLOBAL HEADQUARTERS:

Two Technology Place, East Syracuse, NY 13057 USA
Tel: +1.315.434.1100 Fax: +1.315.437.3803 E-mail: reachus@inficon.com

UNITED STATES FRANCE GERMANY LIECHTENSTEIN SWITZERLAND UNITED KINGDOM CHINA JAPAN KOREA SINGAPORE TAIWAN

Visit our website for contact information and other sales offices worldwide. www.inficon.com
Due to our continuing program of product improvements, specifications are subject to change without notice.
siba36e1 (2004-05) ©2003 INFICON Inc.