

# VSM DN 16 – DN 100

## Vacuum Safety Valves

### ADVANTAGES

- Fast-closing high vacuum isolation valve for separating the vacuum chamber from the backing pump
- Venting valve for roughing pumps
- Immediate closing action upon power failure
- Opening action only after the intake line has been evacuated



### SELECTION DATA

Vacuum connection	DN 16 ISO-KF	DN 25 ISO-KF	DN 40 ISO-KF	DN 63 ISO-K	DN 100 ISO-K
-------------------	--------------	--------------	--------------	-------------	--------------

### ORDERING INFORMATION

Type	VSM016-A	VSM025-A	VSM040-A	VSM063-A	VSM100-A
200 - 230 V AC	253-004	253-014	253-024	253-034	253-044
100 - 115 V AC	253-002	253-012	253-022	253-032	253-042
24 V DC	253-000	253-010	253-020	253-030	253-040

### SPECIFICATIONS

Nominal power	DC AC	2.5 W 5 / 3.7 VA (starting / holding)				
Type of protection		IP 65 according to DIN 40 050				
Conductance		3.8 l/s	11 l/s	30.5 l/s	126 l/s	300 l/s
Installation position		any				
Tightness	body valve plate	< 1x10 <sup>-9</sup> mbar l/s < 1x10 <sup>-5</sup> mbar l/s				
Pressure range		1x10 <sup>-8</sup> mbar – 1 bar (abs.)				
Required pressure difference up for the safety valves to function properly	in closing direction in opening direction	> 150 mbar < 150 mbar				
Temperatures	ambiance	5°C – 50°C				
Solenoid coil	ambiance 20°C ambiance 20°C	< 55°C < 80°C				
Bakeout	housing actuator	< 60°C < 50°C				
Materials	housing, flange seals	aluminum FPM				
Weight		0.3 kg	0.5 kg	0.9 kg	2.4 kg	5.1 kg

## SPARE PARTS

Seal set	215-055	215-056	215-057	215-058	215-059
----------	---------	---------	---------	---------	---------

## DIMENSIONS

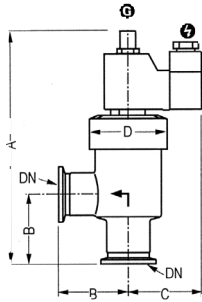

DN	A	B	C	D
DN 16 ISO-KF	139	40	49	44
DN 25 ISO-KF	162	50	49	56
DN 40 ISO-KF	178	65	49	82

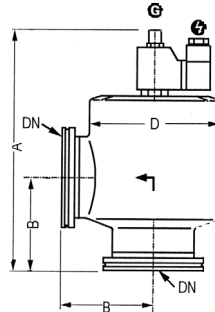

DN	A	B	D
DN 63 ISO-K	220	88	124
DN 100 ISO-K	264	108	164



### GLOBAL HEADQUARTERS:

Two Technology Place, East Syracuse, NY 13057 USA  
 Tel: +1.315.434.1100 Fax: +1.315.437.3803 E-mail: reachus@inficon.com

UNITED STATES FRANCE GERMANY LIECHTENSTEIN SWITZERLAND UNITED KINGDOM CHINA JAPAN KOREA SINGAPORE TAIWAN

Visit our website for contact information and other sales offices worldwide. [www.inficon.com](http://www.inficon.com)  
 Due to our continuing program of product improvements, specifications are subject to change without notice.  
 siba33e1 (2004-05) ©2003 INFICON Inc.