

FLANGES

ISO-KF Small Flange Components

BLANK FLANGE	DN ... ISO-KF	Part No.	A
Aluminum 6012/-	10	211-176	5
	16	211-177	5
	25	211-178	5
	40	211-179	5
	50	211-180	6
Stainless steel 304/1.4301	10	211-181	5
	16	211-182	5
	25	211-183	5
	40	211-184	5
	50	211-185	6

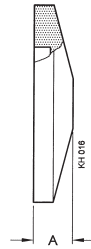

FLANGE WITH TUBE, SHORT	DN ... ISO-KF	Part No.	A	B	C
Steel -/1.0037	10	211-201	20	12	16
	16	211-202	20	16	20
	25	211-203	20	26	30
	40	211-204	20	41	45
	50	211-205	20	51	55
Stainless steel 304/1.4301	10	211-211	20	12	16
	16	211-212	20	16	20
	25	211-213	20	26	30
	40	211-214	20	41	45
	50	211-215	20	50	54

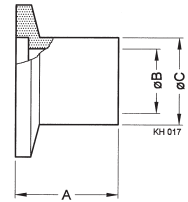

FLANGE WITH TUBE, LONG	DN ... ISO-KF	Part No.	A	B	C
Steel -/1.0037	10	211-206	70	12	16
	16	211-207	70	16	20
	25	211-208	70	26	30
	40	211-209	70	41	45
	50	211-210	70	51	55
Stainless steel 304/1.4301	10	211-216	70	12	16
	16	211-217	70	16	20
	25	211-218	70	26	30
	40	211-219	70	41	45
	50	211-220	70	50	54

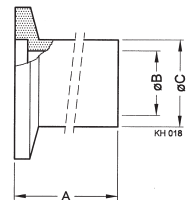



GLOBAL HEADQUARTERS:

Two Technology Place, East Syracuse, NY 13057 USA
Tel: +1.315.434.1100 Fax: +1.315.437.3803 E-mail: reachus@inficon.com

UNITED STATES FRANCE GERMANY LIECHTENSTEIN SWITZERLAND UNITED KINGDOM CHINA JAPAN KOREA SINGAPORE TAIWAN

Visit our website for contact information and other sales offices worldwide. www.inficon.com
Due to our continuing program of product improvements, specifications are subject to change without notice.
qiba03e1 (2004-04) ©2003 INFICON Inc.