

TripleGauge™ BCG450

Bayard-Alpert Pirani Capacitance Diaphragm Gauge

The INFICON Bayard-Alpert Pirani Capacitance Diaphragm Gauge, BCG450, combines the advantages of three different technologies in a single, compact, economical package to measure process and base pressure from 5×10^{-10} to 1500 mbar (3.75×10^{-10} to 1125 Torr). The BCG450 is designed to take the place of three sensors (hot ion, convection enhanced Pirani and vacuum switch), thus reducing cost and valuable tool space.

ADVANTAGES

- BCG450 saves cost and tool space and reduces the complexity of vacuum measurement installation and setup
- Gas-type-independent pressure measurement above 10 Torr provides more reliable loadlock control for any gas-mixture
- Pirani interlock protects the hot filament from premature burnout
- Automatic high vacuum and atmospheric Pirani adjustment reduces operator interventions
- Differential pressure measurement at atmosphere eliminates uncertainty related to atmospheric pressure changes
- Easy-to-exchange sensing element with on-board calibration data guarantees reproducibility
- Optional graphic display and Fieldbus interfaces available

APPLICATIONS

- Pressure measurement in Semiconductor process, transfer and loadlock chambers
- Industrial coating
- General vacuum measurement and control on systems in the low to ultra high vacuum range



ORDERING INFORMATION

Type	BCG450 without LCD display	BCG450 with LCD display	BCG450-SP with Profibus DP ¹⁾	BCG450-SD with DeviceNet ¹⁾	BCG450-SR with RS485 ¹⁾
DN 25 ISO-KF	353-550	353-552	353-554	353-557	353-559
DN 40 CF-R	353-551	353-553	353-556	353-558	353-560
Replacement sensor 25 ISO-KF	354-492	354-492	354-492	354-492	354-492
Replacement sensor 40 CF-R	354-493	354-493	354-493	354-493	354-493
Available	1.Qt 2004	on request	on request	1.QT 2004	on request

¹⁾ not available with LCD display

ACCESSORIES

Power supply 24V DC / RS 232 C line	353-511
Baffle	353-512

SPECIFICATIONS

			BCG450 Standard	BCG450 Display
Measurement range	mbar (Torr)		5×10^{-10} to 1500	$(3.75 \times 10^{-10}$ to 1125)
Accuracy	10^{-8} to 10^{-2} mbar	% of reading	15	
	10^{-2} to 50 mbar	% of reading	15	
	50 to 950 mbar	% of reading	5	
	950 to 1050 mbar	% of reading	2.5	
Hot ion emission on (selectable high / low, via RS232 / Fieldbus)	mbar		2×10^{-2} (high)	
	mbar		8×10^{-3} (low)	
Degas ¹⁾ $p < 7.2 \times 10^{-6}$	mbar		Electron bombardment, max. 3 min	
Pressure, max. absolute	bar		5	
Temperature				
Operation (ambient)	°C		0 to +50	
Storage	°C		-20 to +70	
Bakeout				
at flange	°C		80	
electronics removed	°C		150	
Supply	V / A DC		20 to 28 / 0.8	
Output signal analog				
Measurement range	V		0 to 10.3	
Relation voltage / pressure	V / Decade		0.75	
Error signal	V		0.3 / 0.5	
Minimum load	kΩ		10	
Interface (digital) ²⁾			RS232C	
Connector			D-sub, 15 pin, male	
Cable length, max. ³⁾	m (ft)		100 (330)	
Materials exposed to vacuum			Yttrium oxide, iridium, stainless steel, molybdenum, Cu, W, glass, NiFe, NiCr, Al ₂ O ₃ , SnAg	
Internal volume KF / CF	cm ³ (inch) ³		24 (1.46) / 34 (2.1)	
Weight KF / CF	g		285 / 550	
Protection type			IP30	

¹⁾Reduced accuracy during degas

²⁾Simultaneous use of RS232C or VGC400 series controllers and Fieldbus is not allowed

³⁾RS232C operation <30m

BCG450 Standard

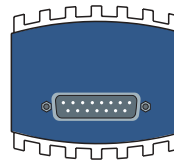

BCG450 with LCD display option

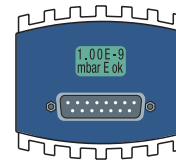

SPECIFICATIONS

			BCG450-SD DeviceNet™
Protocol			DeviceNet™, group 2 slave only
Data rate switch	kBaud		125, 250, 500 or network programmable
Cable length			
125 kbps	m (ft)		500 (1650)
250 kbps	m (ft)		250 (825)
500 kbps	m (ft)		100 (330)
MAC ID			2 switches (address 00 - 63) or network programmable
Network size			Up to 64 nodes per segment
Digital functions			Read pressure, select units: Torr, mbar, Pa Degas function Monitor gauge status Safe state allows definition of behavior in case of error Detailed alarm and warning information
Analog functions			0 to 10 V analog output pressure indication Two setpoint relays A + B
Visual communication indicators			LED network status (green / red) LED module status (green / red)
Specification			DeviceNet™ "Vacuum Gauge Device Profile"
Device type			"CG" for combination gauge
Explicit peer to peer messaging			no
I / O peer to peer messaging			no
Configuration consistency value			no
Faulted node recovery			no
Baud rates	kBaud		125 / 250 / 500
Master / Scanner			no
I / O slave messaging			
Bit Strobe			no
Polling			yes
Cyclic			no
Change of State (COS)			no
Setpoint relays			2
Range	mbar		1×10^{-9} to 1400
Relay contact			n.o., potential free
Hysteresis	% of reading		10
Contact rating	V / A DC		60 / 0.5
Connector			D-sub, 15 pin, male
Supply for DeviceNet™	V / A DC		11 to 25 / 0.5
Supply for gauge	V DC		20 to 28
Connector for DeviceNet™			Microstyle, 5 pin
Connector for BCG, analog output and power supply			D-sub, 15 pin, male

BCG450 DeviceNet™

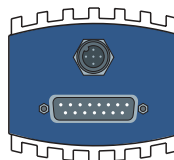

SPECIFICATIONS

			BCG450-SP Profibus DP
Baud rates	kBaud MBaud		9.6 / 19.2 / 93.75 / 187.5 / 500 1.5 / 12
Address			2 switches (address 00 - 127) or network programmable
Digital functions			Read pressure, select units: Torr, mbar, Pa Degas function Monitor gauge status Safe state allows definition of behavior in case of error Detailed alarm and warning information
Analog functions			0 to 10 V analog output pressure indication Two setpoint relays A + B
Expanded user parameter data			No
Sync-Mode and Freeze-Mode			No
Connector			D-sub, 9 pin, female
Setpoint relays			2
Range	mbar		1×10^{-9} to 1400
Relay contact			n.o., potential free
Hysteresis	% of reading		10
Contact rating	V / A DC		60 / 0.5
Connector			D-sub, 15 pin, male

BCG450 Profibus DP

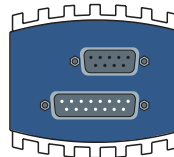

SPECIFICATIONS

			BCG450-SR RS485
Baud rates	kBaud		0.3 / 1.2 / 2.4 / 4.8 / 9.6 / 19.2 / 28.8
Address			2 switches (address 00 - 127) or network programmable
Digital functions			Read pressure, select units: Torr, mbar, Pa Degas function, Pirani full scale adjust Monitor gauge status Detailed alarm and warning information
Analog functions			0 to 10 V analog output pressure indication Two adjustable setpoint relays A + B
Connector			
for RS485			D-sub, 9 pin, male
for gauge (analog output, power, setpoints)			D-sub, 15 pin, male
Setpoint relays			2
Range	mbar		1×10^{-9} to 100
Relay contact			n.o., potential free
Hysteresis	% of reading		10
Contact rating	V / A DC		60 / 0.5

BCG450-SR with RS485

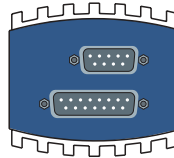

DIMENSIONS

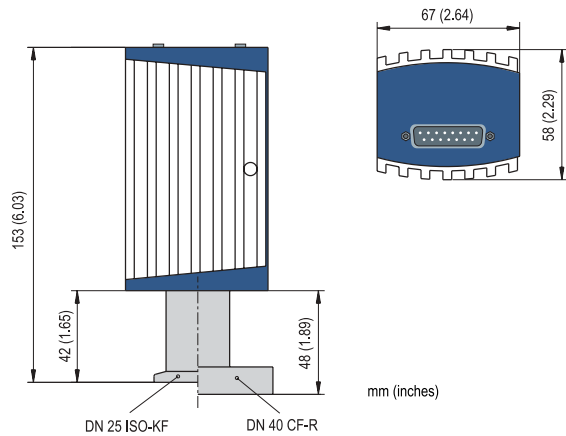

ACCESSORIES

Power supply 24 V DC / RS 232 C line

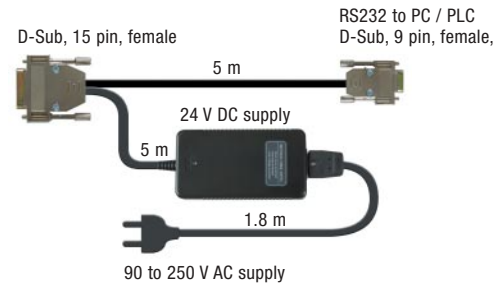

Baffle:

Prevents contamination of the sensor.
Easy installation into the vacuum connection - no tools required.

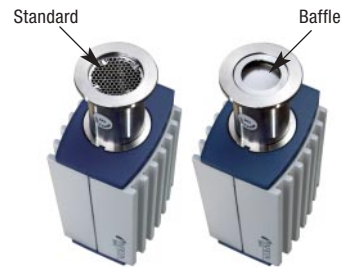

INFICON Instruments for Intelligent Control™

GLOBAL HEADQUARTERS:

Two Technology Place, East Syracuse, NY 13057 USA
Tel: +1.315.434.1100 Fax: +1.315.437.3803 E-mail: reachus@inficon.com

UNITED STATES FRANCE GERMANY LIECHTENSTEIN SWITZERLAND UNITED KINGDOM CHINA JAPAN KOREA SINGAPORE TAIWAN

Visit our website for contact information and other sales offices worldwide. www.inficon.com
Due to our continuing program of product improvements, specifications are subject to change without notice.
tiba12e1-a ©2003 INFICON